

MODEL NO. : TB30 / TB35

SPECIFICATION:

| NO. | ITEM | PARAMETER | UNIT |
|-----|-------------------------|---------------------------|--------|
| 1 | RATED VOLTAGE | 100-240 | V |
| 2 | RATED INPUT POWER | 1200 ±8% | W |
| 3 | INPUT CURRENT | 5,6 | A |
| 4 | MAX. OUTPUT POWER | >400 | W |
| 5 | RATED FREQUENCY | 50/60 | Hz |
| 6 | MAX. VACUUM DEGREE | 27 -5% | Kpa |
| 7 | MAX. AIR FLOW | 3.2 -5% | m3/min |
| 8 | MAX. SUCTION EFFICIENCY | 39 -5% | |
| 9 | SPARK | <2 | |
| 10 | NOISE | <96 | dB |
| 11 | VIBRATION | <15 | mm/s |
| 12 | DURABLE | 1800v/s | |
| 13 | INSULATION RESISTANCE | >20 | MΩ |
| 14 | TEMPERATURE RISK | <85 | K |
| 15 | SPEED | MAX. RPM UNLOADED | >34000 |
| 16 | | LOADED RPM | <31000 |
| 17 | OVER SPEED TEST | 30S(PARTS REMAINS NORMAL) | |
| 18 | DUTY TYPE | S1 | |
| 19 | LIFE | >500 | Hours |
| 20 | ROTATION DIRECTION | COLOUR WISE | |

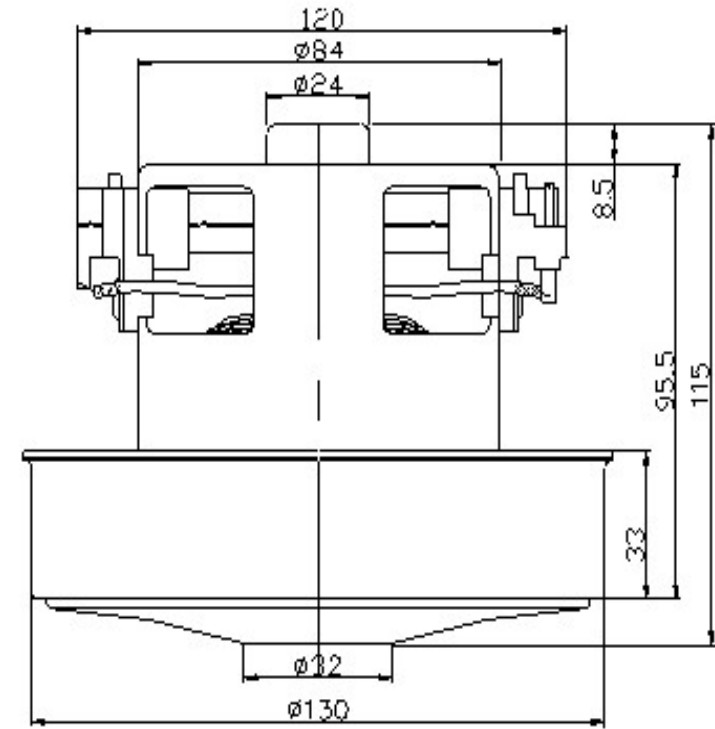

DIAGRAM OF EXTERNAL MEASUREMENT AND PHOTO:

