

| TECHNICAL SPECIFICATIONS | | |
|-------------------------------------|----------|-----------|
| VOLTAGE/FREQ. | (V/Hz) | 230/50 |
| POWER (GÜÇ) | (W) | 22 |
| CURRENT (AKIM) | (mA) | 150 |
| RESISTANCE (DİRENÇ) | (Ω) | 195 +-%6 |
| SPEED (DEVİR) | (rpm) | 1500-1600 |
| AIR FLOW SPEED (HAVA HIZI) | (m/s) | 5,6 |
| AIR FLOW RATE (HAVA DEBİSİ) | (m³/h) | 130 |
| Operating Temp. (Çalışma Sıcaklığı) | | T125 |
| Insulation (izolasyon) | | Class H |

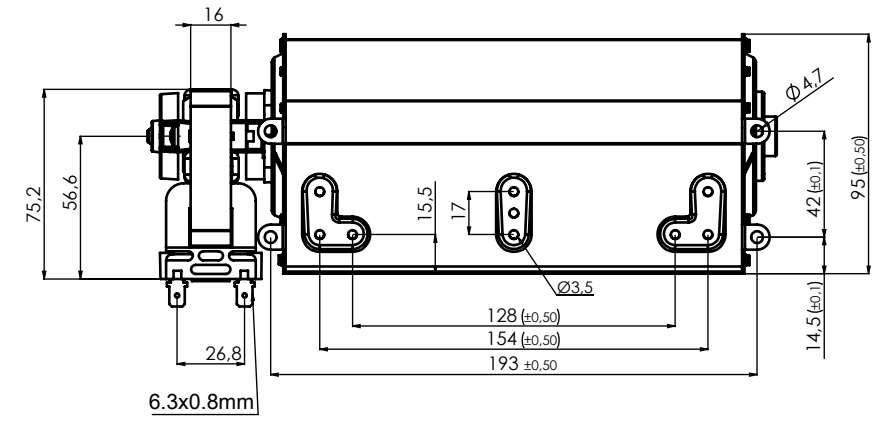
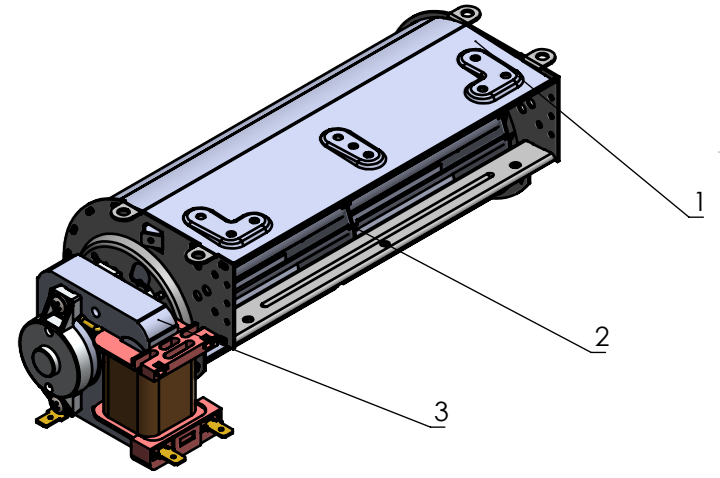
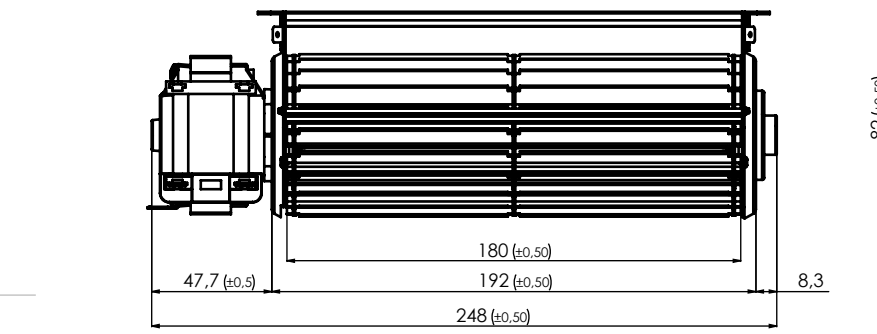

AKSA MOTOR FAN
MOD: AKS-680-180
 220-240V 50/60Hz 22 W
 CLASS (H) RoHS
MADE IN TURKEY Pr. Dt.: 10 / 2015

| Part Name | Material Type |
|------------------|--|
| 1 Body(Gövde) | 0,8mm Zinc Coated (Galvanized) Steel Sheet (Çinko Kaplı Çelik Sac) |
| 2 Fan(Pervane) | 0,5mm Aluminum (Alüminyum) |
| 3 Stator(Statör) | 0,5mm DC01 Steel Sheet (Çelik Sac) |

| REVISIONS | REV | DESCRIPTION | APP | DATE | MATERIAL | WEIGHT |
|-----------|-----|-------------|---|------|------------|--------|
| | 01 | | This motor is made upon request of customer due to the design change in the mesh. | | 27.09.2014 | |

| NAME | SIGNATURE | DATE |
|---------------------|-----------|------------|
| PREP. BY H.BAĞIR | | 16.11.2021 |
| APPROVED BY K.ERDEM | | 16.11.2021 |
| CONT. BY H.ÖZTÜRK | | |

STANDART:
 Refer to ISO 2768 MK standards for the unspecified tolerances. (Tolerance Class Designation: Fine)

AKSA MOTOR FAN
AKSA MOTOR FAN SAN. TİC. LTD. ŞTİ.

EXPLANATION:
 PART NAME : Soğutma Fanı (Cooling Fan)
 PART NO : AKS 680-180
 REFERANS NO :

A4
 SCALE:1:3
 SAYFA 1 / 1